



Restaurant Menu Board

Directory, Vista Sharp series

2 end-caps style



Vista Sharp's single panel wall directory is based on the system's standard extrusions plus movable divider strips between the graphic strips, resulting in an easy to assemble sign and enables frequent graphics' changes.

Dimensions:

Vista Sharp directory sign frames are offered in 2 different widths:

11", 11.69"

(FRL11, FRL-A3)

Length: 9.5'-16.5" (240 mm – 416 mm)

Custom lengths are available.

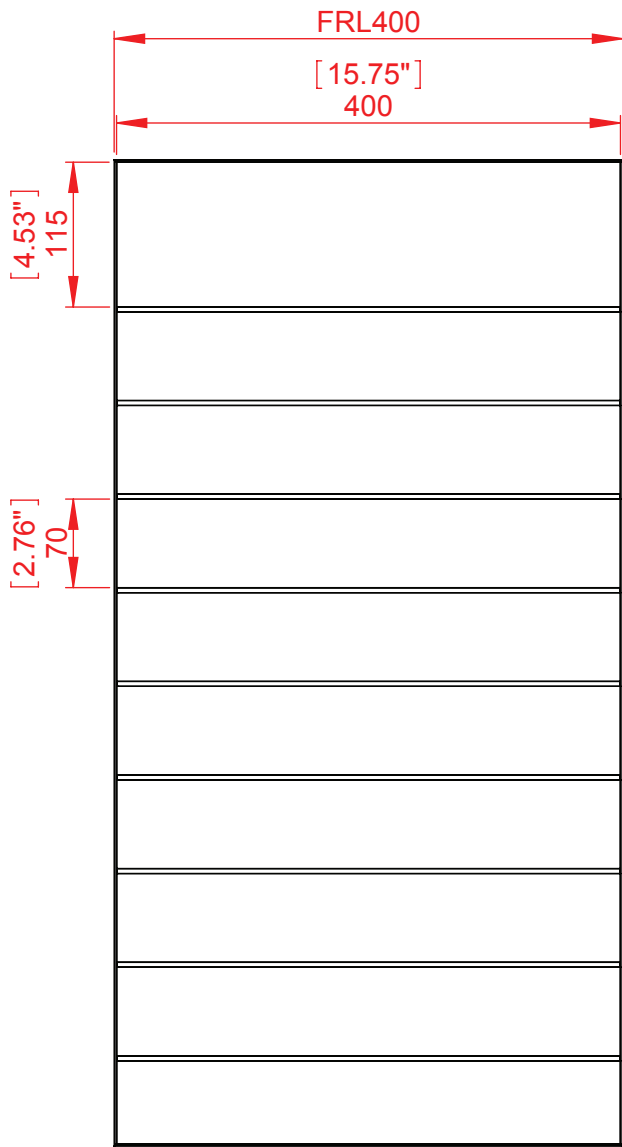

Front view

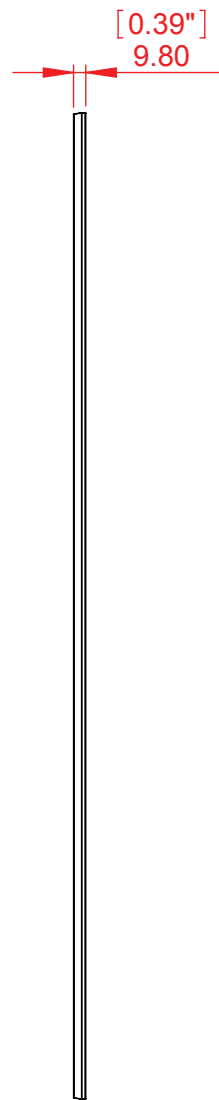

Side view

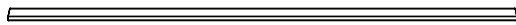

Top view

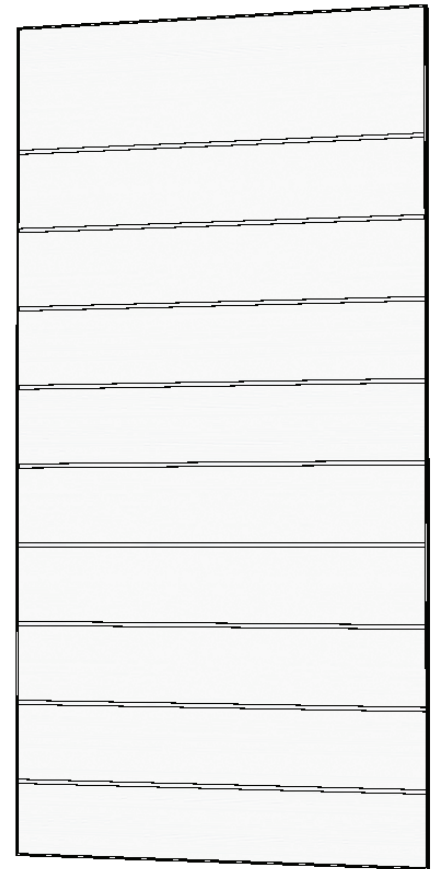

Isometric view



Product Series	Sharp system	Designer: R.C
Model	Diretcory Sharp style 400x115 + 6x70 size	Date: 18/12/2016
Part Number	NCPVS1	Scale: 1:5
Drawing Number	VSH.36	Measurements in millimeters Do not scale drawing

Proprietary and confidential: The information contained in this drawing is the sole property of Vista system Limited. Any reproduction; copying; distribution or any other use in part or as a whole without the written permission of Vista system Limited is prohibited. This ban includes any use by any third party that did not receive this information from Vista system Limited.