

# Sign Frames

## Suspended Sign, Vista Sharp series



Vista Sharp's flat designed double sided hanging sign is based on Sharp's standard double sided profile and specially designed connectors that are also cable clamps.

### **Dimensions:**

Vista Sharp sign frames are offered in 13 different widths:

4.14", 5.83", 8.27", 8.5", 11", 11.69", 14", 15.75", 16.54", 17", 19.68", 22", 23.62"

(FRL-A6, FRL-A5, FRL-A4, FRL-Letter, FRL11, FRL-A3, FRL14, FRL-400, FRL-420, FRL-17, FRL500, FRL22, FRL600 (mm))

Length: 16"-40" (400 mm – 1000 mm)

Custom lengths are available.

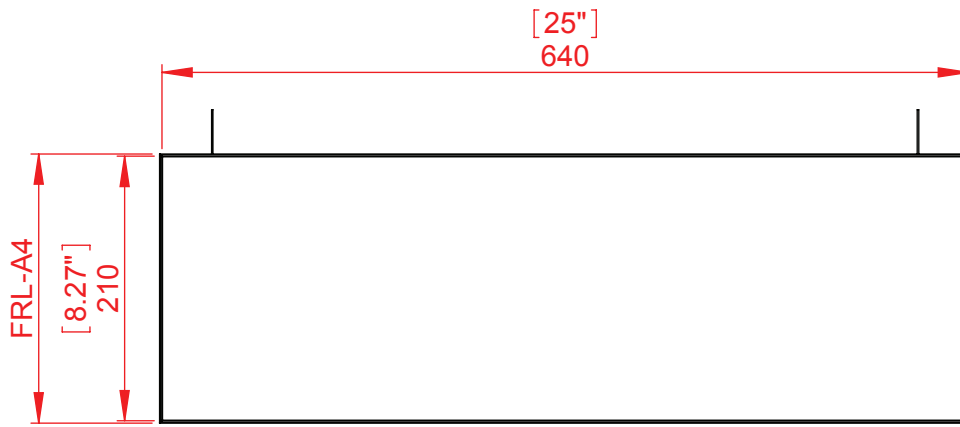

Front view

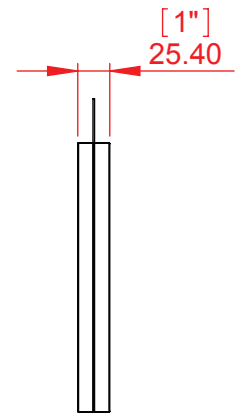

Side view

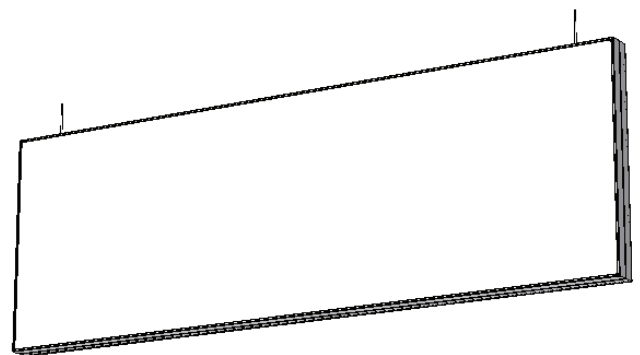

Isometric view



Product Series	Sharp system	Designer: R.C
Model	Suspended Sharp style A4x640 size	Date: 13/12/2016
Part Number	SUSS4E11	Scale: 1:6
Drawing Number	VSH.31	Measurements in millimeters Do not scale drawing

**Proprietary and confidential:** The information contained in this drawing is the sole property of Vista system Limited. Any reproduction; copying; distribution or any other use in part or as a whole without the written permission of Vista system Limited is prohibited. This ban includes any use by any third party that did not receive this information from Vista system Limited.